

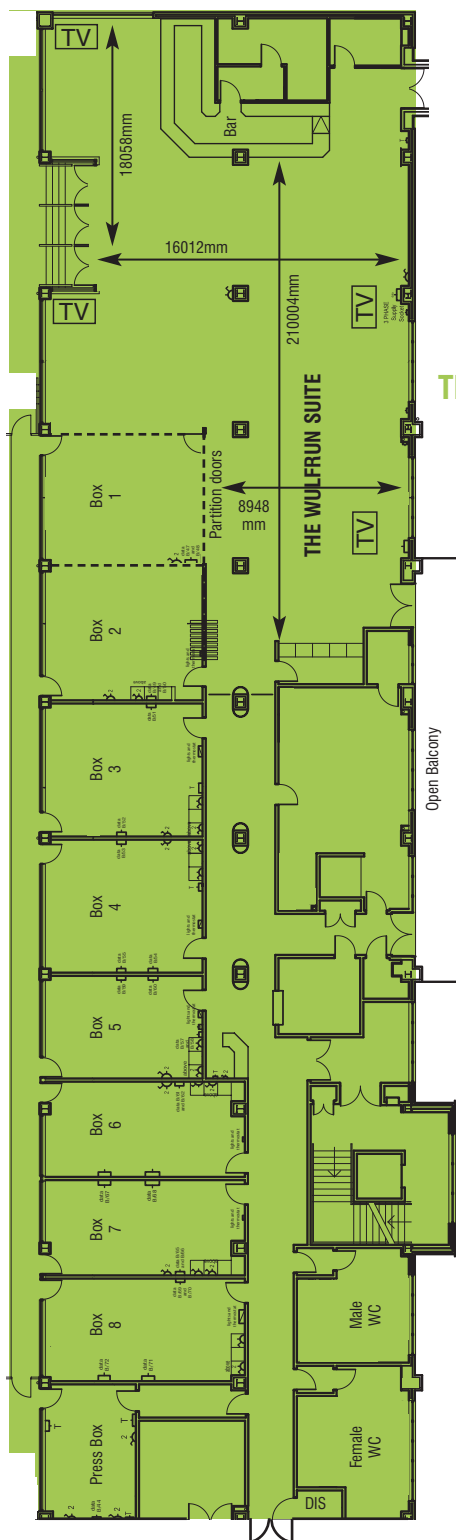



# The Room Layouts

## The First Floor

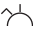
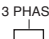

The Wulfrun Suite

### KEY

T	Std. Telephone Socket
	Switched Socket Outlet
	3 Phase Socket
	General Switches e.g. lights, extractor & music control
	Std. 28" TV ceiling mounted
---	Partition Doors
	Room Dimensions
<b>DIS</b>	Disabled Toilets

# The Room Layouts

## The Ground Floor



# The Room Layouts

## The First Floor

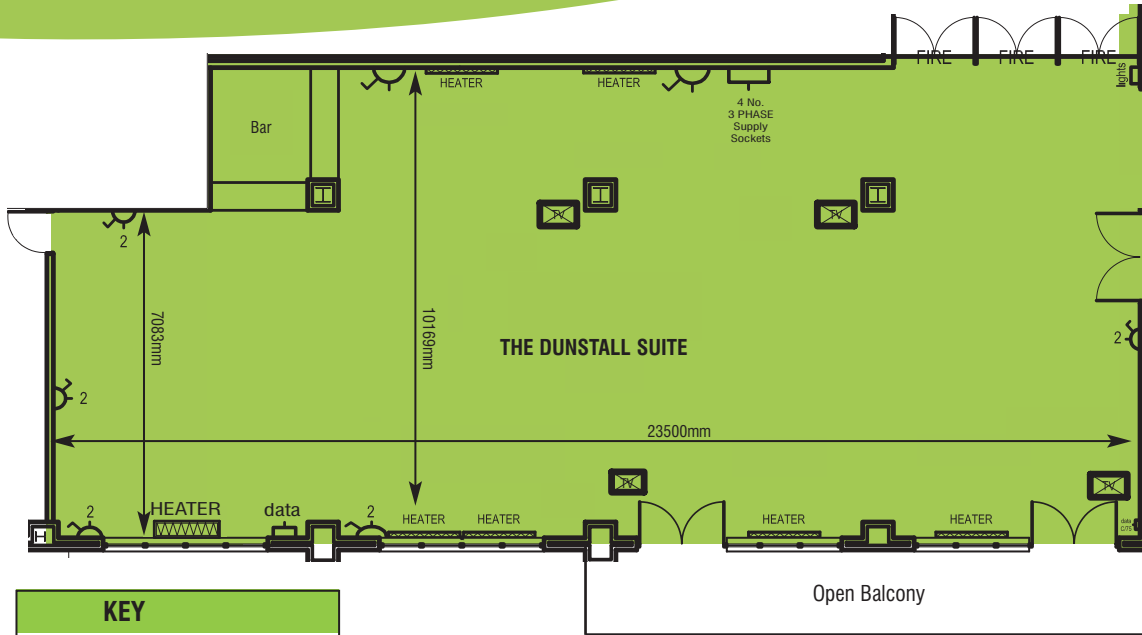

The Dunstall Suite

KEY	
T	Std. Telephone Socket
	Switched Socket Outlet
	3 Phase Socket
	General Switches e.g. lights, extractor & music control
	Std. 28" TV ceiling mounted
	Partition Doors
	Room Dimensions



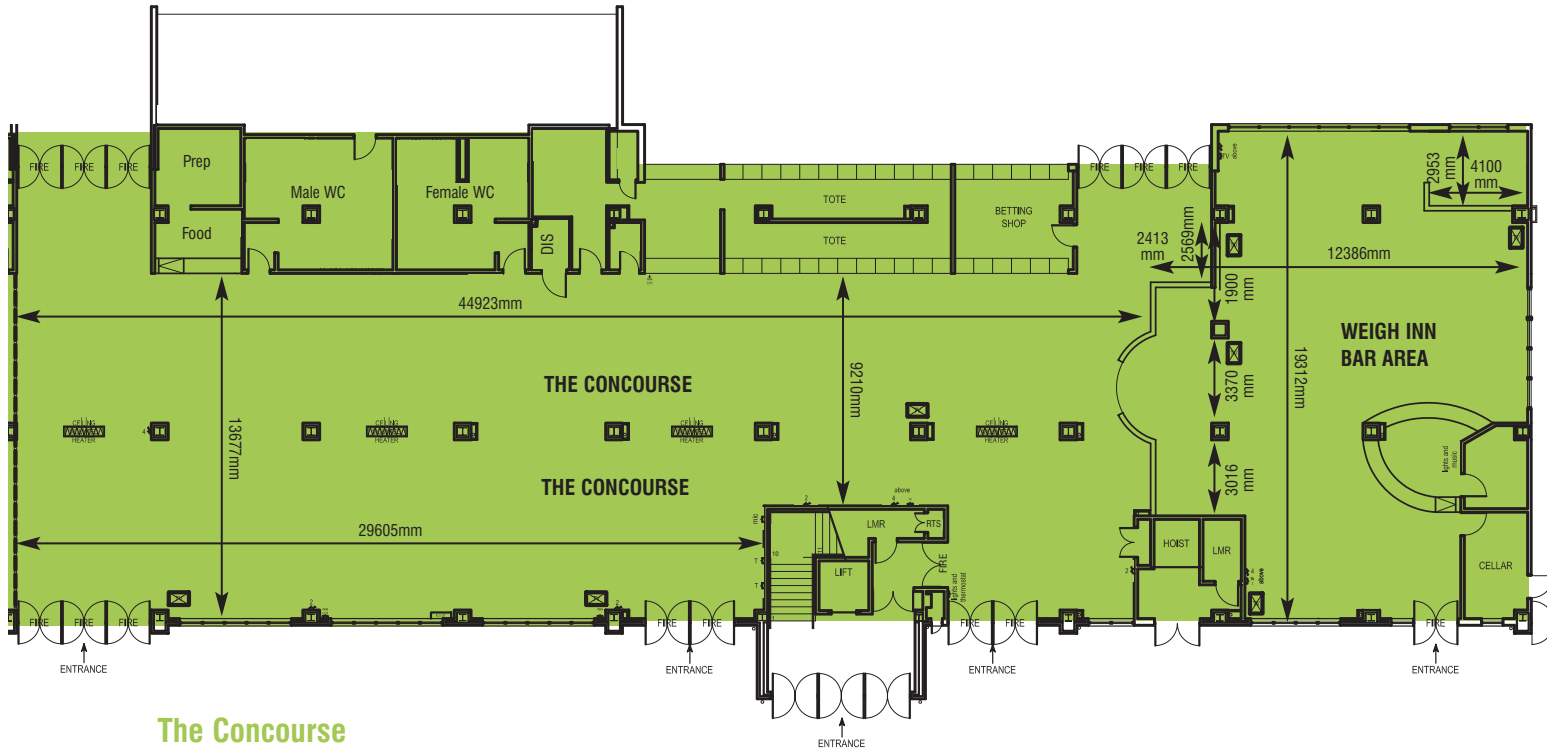

Room Name	Reception	Theatre	Classroom	u Shape	Banquet	Dimensions	Height	Door h/w	Location (Floor)	Black Out Facility
Wulfrun Suite	400	250	115	80	250	22 x 16	2.59	1.70 x 2.00	1	Yes
Dunstall Suite	115	115	80	60	80	24 x 10	2.50	1.70 x 2.00	1	Yes
<b>Conference Rooms</b>										
1 & 2	80	70	30	30	64	12 x 7.0	2.59	1.93 x 0.92	1	Yes
3 x 4	40	35	15	18	32	7.0 x 5.8	2.59	1.93 x 0.92	1	Yes
5	25	25		10	16	7.0 x 4.3	2.59	1.93 x 0.92	1	Yes
6,7,8	35	30	15	15	24	8.7 x 4.3	2.59	1.93 x 0.92	1	Yes
The Ringside	750	700	350		600	28 x 24	5.50 max	4.00 x 2.60	G	Yes
Lesters	60	30	20	20	45	12 x 5.9	2.60	1.95 x 0.75	1	Yes
The Concourse	600	-	-	-	-	48.13.5	3.05 max	2.03 x 1.75	G	No

# The Room Layouts

## The Ground Floor

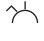
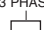

The Concourse

KEY	
T	Std. Telephone Socket
	Switched Socket Outlet
3 PHASE 	3 Phase Socket
	General Switches e.g. lights, extractor & music control
	Std. 28" TV ceiling mounted
----	Partition Doors
	Room Dimensions
DIS	Disabled Toilets