



CONFERENCES, EXHIBITIONS & SPECIAL EVENTS

business, leisure & occasions



choose your favourite

A FAVOURITE FOR EVENTS

Wolverhampton Racecourse is ideally located for conferences, meetings, exhibitions and outside events. It is close to the M6 and M54 motorways, less than 2 miles from Wolverhampton city centre, 25 miles from Birmingham, and yet is set in a quiet location surrounded by 20 acres.

With experience in many types of events ranging from product launches and computer fairs to circuses, car

launches and demonstrations, hairdressing competitions and pop concerts, the self contained complex is highly adaptable and can suit almost any occasion or requirement.

There is a range of conferencing suites seating up to 700 theatre style, with any style of layout accommodated.



NON-RACING EVENTS

Our friendly and helpful staff are on hand to assist with your requirements, and our co-ordinators liaise extensively with you prior to the event to ensure smooth running. Day delegate and 24 hour delegate rates are available, or you can choose the room hire option.

The 19 acres in the centre of the race track provide an ideal grassed venue for tented shows and displays, fun days, or team building events. There is vehicular access and our catering team can supply external catering units if required.

“ Everything went as planned and it was an excellent venue for us - your staff were polite and helpful at all times and we were all impressed with the professional set up at the Holiday Inn and Racecourse. ”
Bev Bish - Head of Finance and Corporate Assurance, HMP Featherstone



- | | |
|--|--|
| 1. Grandstand & Premier Entrance (access to trackside) | 12. The Wulfrun Suite Leading to Executive Hospitality Boxes and Press Box (1st Floor) |
| 2. The Ringside Suite / Restaurant | 13. Weigh Inn Room |
| 3. Chasers Bar | 14. Hotel Bedrooms |
| 4. Entrance to Chasers Bar and The Ringside | 15. The Parade Restaurant (entrance via Hotel Reception) |
| 5. The Dunstall Suite (1st Floor) | 16. Hotel Reception, Horizons Restaurant Entrance |
| 6. Grandstand | 17. Race Track |
| 7. Parade Ring | |
| 8. The Concourse | |
| 9. Lift & Stairs to all Floors | |
| 10. Horizons Restaurant (3rd Floor) | |
| 11. Weigh Inn Bar | |

Number of bedrooms - 54

Number of meeting rooms - 12

MEETING ROOM INFORMATION

Room name		Wulfrun	Dunstall	1 & 2	3 & 4	6, 7 & 8	Ringside	Concourse
Floor		first	first	first	first	first	ground	ground
Lift to floor level		yes	yes	yes	yes	yes	no	no
Capacities	theatre	150	120	70	30	25	600	-
	classroom	80	60	25	18	14	-	-
	boardroom	50	50	25	18	16	-	-
	U-shape	40	40	25	16	14	-	-
	lunch / dinner	250	100	64	32	24	500	-
	dinner dance	200	80	40	-	-	420	-
	reception	350	200	70	40	35	700	700
	cabaret	100	80	40	24	12	320	-
Dimensions	length							
	feet	72'2"	78'9"	39'4"	23'	28'7"	91'10"	157'6"
	metres	22.00	24.00	12.00	7.00	8.70	28.00	48.00
	width							
	feet	52'6"	32'10"	23'	19'	14'1"	78'9"	44'3"
	metres	16.00	10.00	7.00	5.80	4.30	24.00	13.50
area								
sq. ft	-	-	-	-	-	-	-	-
sq. m	-	-	-	-	-	-	-	-
Height (maximum)	feet	8'6"	8'2"	8'6"	8'6"	8'6"	18'1"	10'
	metres	2.59	2.50	2.59	2.59	2.59	5.50	3.05
Height (minimum)	feet	8'6"	8'2"	8'6"	8'6"	8'6"	17'5"	10'
	metres	2.59	2.50	2.59	2.59	2.59	5.30	3.05

TECHNICAL INFORMATION

Lighting	tung/fluor/hal	fl	fl/hal	fl	hal	hal	fl/hal	fl
	controls in room	yes	yes	yes	yes	yes	yes	yes
	dimmers	no	no	no	no	no	no	no
	black out	yes	yes	yes	yes	yes	yes	no
	windows	yes	yes	yes	yes	yes	yes	yes
Sound system fitted	yes	yes	no	no	no	yes	no	
Power	13A sockets	3	7	3	2	2	15	6
	3-phase available	yes	yes	no	no	no	yes	no
Access door height	feet	6'5"	6'5"	6'6"	6'6"	6'6"	12'2"	6'6"
	metres	1.95	1.95	1.97	1.97	1.97	3.70	1.97
Door width	feet	5'5"	5'4"	2'6"	2'6"	2'6"	8'10"	5'7"
	metres	1.65	1.62	0.76	0.76	0.76	2.70	1.69
Miscellaneous	no. of tel. points	2	3	1	1	1	1	-
	air conditioning	no	no	no	no	no	no	no

Conference equipment

Flipcharts x 7, screens x 5, data projector x 1, TV and DVD x 8 (fixed in rooms)



RINGSIDE SUITE

The Ringside Suite, situated on the ground floor is a 680 square metre pillar free, carpeted hall, which together with the adjoining Concourse creates 1400 square metres of exhibition space with vehicular access.

There is a licensed bar within the Ringside as well as kitchen facilities located adjacent to the room. There are plenty of electrical points including some three phase sockets and pull down viewing screens which may be used for showing

PowerPoint presentations, DVD's or live TV feeds. An additional licensed bar and fast food outlet in the Concourse ensures the adjoining area is also well serviced.

The suite is ideal for:

- Award ceremonies
- Banquets & parties
- Product launches
- Dinner dances
- Exhibitions
- Charity events
- Prom nights
- Training sessions
- Wedding receptions



THE CONCOURSE

The Concourse is situated between the Ringside Suite and Weigh Inn Bar and provides around 500 square metres of space for a wide range of events.

Having two main entrance points from both the Parade Ring and Grandstand sides, the Concourse provides a flexible space which may be utilised on its own or as an adjoining room to the Ringside, increasing the space and flexibility for larger events.

There is a grill bar for food and beverages if required. TV's and electrical points are situated throughout the area.







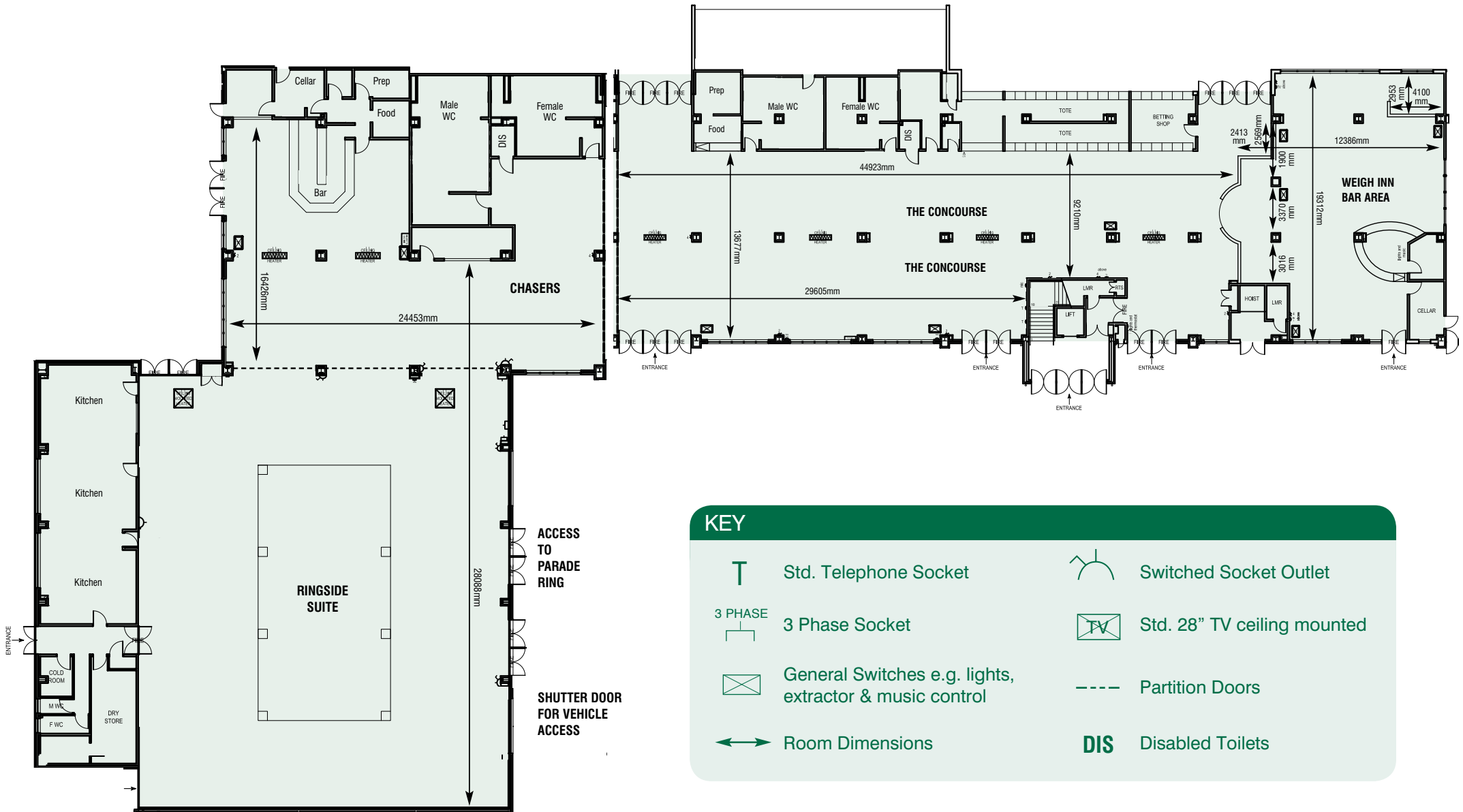

The Concourse has proved popular for use with shell scheme exhibition units, as a meet and greet reception room, as a break out dining area and for cultural ceremonies and events.

RINGSIDE SUITE

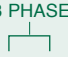
THE CONCOURSE



KEY

	Std. Telephone Socket		Switched Socket Outlet
	3 Phase Socket		Std. 28" TV ceiling mounted
	General Switches e.g. lights, extractor & music control		Partition Doors
	Room Dimensions		Disabled Toilets



your business is our business

WULFRUN SUITE

Ideal for 200 banqueting style or 150 theatre style, the suite is quietly located with views over the racecourse on one side and the Parade Ring on the other, providing natural daylight on two sides.

With a licensed bar and various phase electrical points around the room, the suite is extensively used for wedding receptions, award dinners, conferences, property and travel exhibitions and as a reception area for guests attending the Executive Suites.

“ The event went really well and the venue suited their requirements perfectly, and they would definitely use the venue again. ”

Francesca Pearson - Event Manager, Mosaic Events Ltd.



meet in style

Dunstall Suite

Seating 80 banqueting style or 120 theatre style, the suite is self contained with its own bar and balcony overlooking the Parade Ring. There are doors out to the trackside. This suite is also licensed for civil wedding ceremonies for up to 100 guests.

Executive Suites 1- 8

The Executive Suites vary from the smallest seating 16 for banqueting to the largest seating 64, and each has access to a private balcony overlooking the racetrack and surrounding

parkland. There is daylight from the trackside and these suites are ideal for smaller meetings, interviews, or seminar rooms.

Flipcharts, screens, paper, pens, water and cordials are included in the day delegate and 24 hour delegate rates.

Additional equipment may be ordered or you may bring your own.

Executive Suites 1 & 2 combined are licensed for civil wedding ceremonies seating up to 80 guests.

THE DUNSTALL SUITE

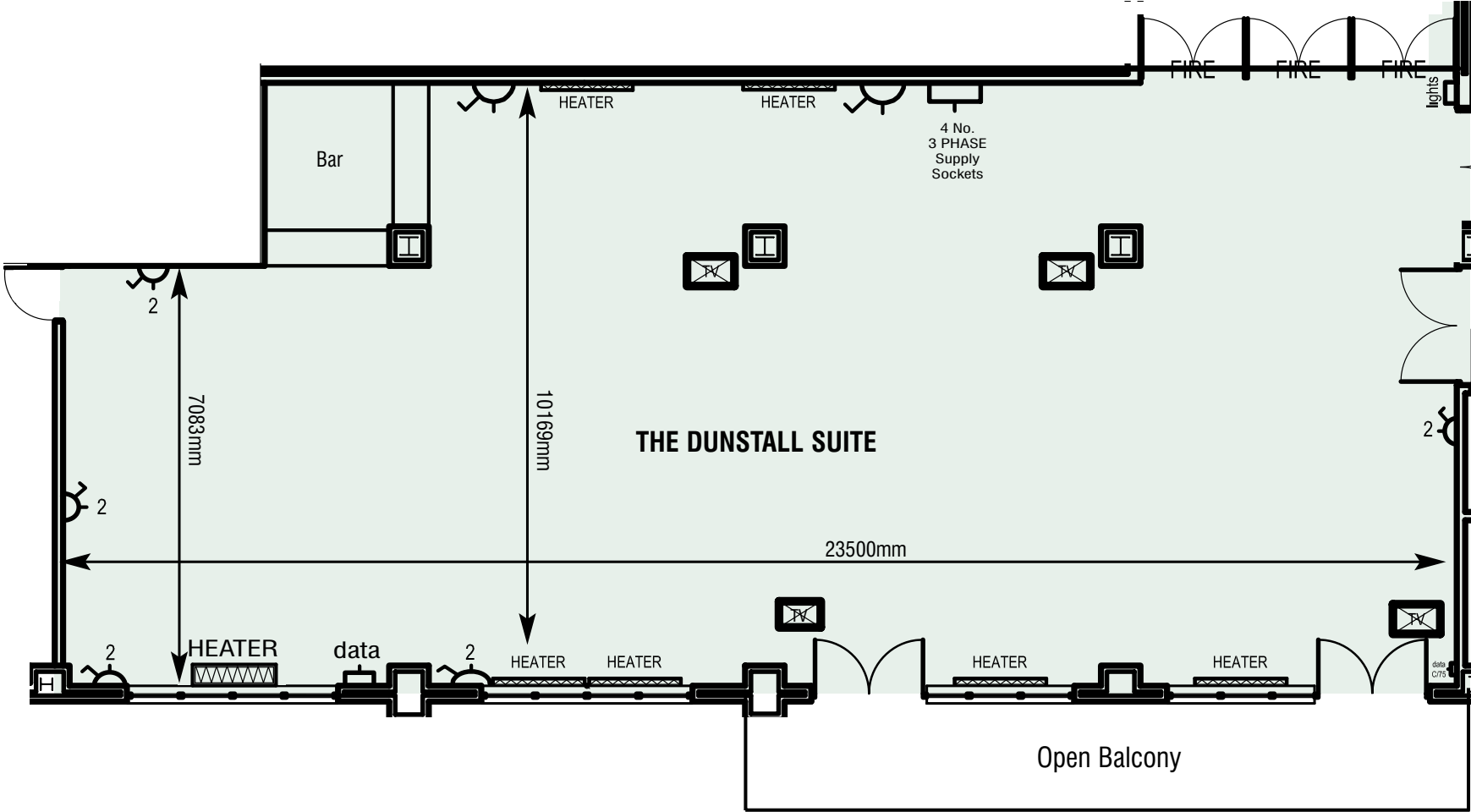

KEY			
T	Std. Telephone Socket	Switched Socket Outlet	3 PHASE 3 Phase Socket
DIS	Disabled Toilets	----- Partition Doors	TV Std. 28" TV ceiling mounted
		↔ Room Dimensions	General Switches e.g. lights, extractor & music control



a room with a view

HORIZONS RESTAURANT

Horizons is situated on the third floor with lift and stair access and has fabulous panoramic views of the race track and surrounding parkland.

Used as a 370 seat tiered restaurant for race meetings, it can also be used for serving meals for conferences and events (subject to availability) and has proved popular for presentations and team building events.

The layout ensures that guests receive excellent views from their table, and the contemporary furniture and fittings along with its size, make it a favourite with event organisers.



share special moments

PARTIES, WEDDINGS AND RECEPTIONS

Whatever the occasion, the tempting and varied menus and talented chefs mean that we can help you select the ideal menu for your event.

We hold a civil wedding licence so that you can tie the knot in a picturesque setting. We can also cater for cultural

weddings where large parties of up to 600 guests can be accommodated in our Ringside Suite and adjoining Concourse. Friendly and accommodating personnel, an on-site hotel and free parking make Wolverhampton Racecourse your first choice for a prestigious event.

“ We would recommend you as a venue to others and our compliments to your hard working chef and team, people were most impressed! ”

Allison Taylor - Head of Organisational Development, Accord Housing Association Ltd.



DISABLED FACILITIES

- Wolverhampton Racecourse has been audited by the Leonard Cheshire Organisation, and 'One Voice' Wolverhampton City Council. The racecourse has been classified by these organisations as accessible.
- Disabled access
- Selected bedrooms suitable for disabled guests
- Disabled parking spaces outside the Holiday Inn Hotel
- Disabled toilets around the racecourse and one off the hotel lobby
- Lifts with Braille buttons
- Hearing aid loops available at Holiday Inn reception on request





relax in comfort and style

THE HOLIDAY INN HOTEL

After your event, why not relax in our on-site Holiday Inn Hotel?

With recognised standards of quality and service, the hotel offers 54 en-suite bedrooms with both bath and shower, tea and coffee making facilities, direct dial telephone and TV with the option of pay-to-view movies. Two of the bedrooms have disabled access.

There is free WiFi access throughout the hotel and free parking for up to 1500 vehicles.

The welcoming Parade Bar and Restaurant are open to non-residents and there is a fitness room for residents with energy to spare!



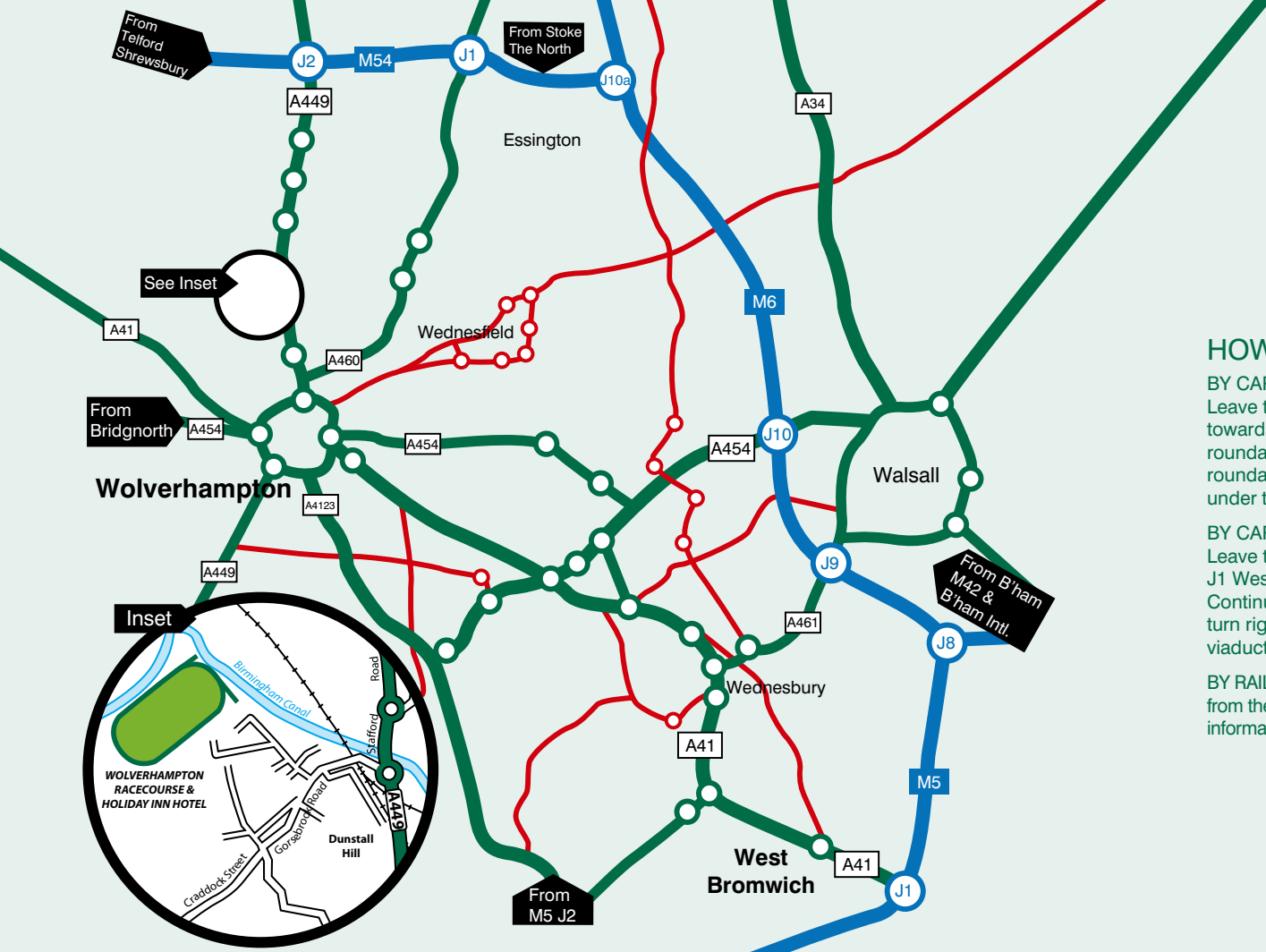

HOW TO FIND US

BY CAR: From M6 Northbound

Leave the M6 at J10a and join the M54. Continue to J2 and join the A449 towards Wolverhampton. Continue for approximately 3 miles straight over 4 roundabouts. Continue past the viaduct on the right-hand side and at the next roundabout turn right on to Gorsebrook Road. Continue 400 yards passing under the viaduct and turn right. We are situated at the end of the road.

BY CAR: From M6 Southbound

Leave the M6 at J11 and join the A460 towards Wolverhampton. Join the M54 at J1 Westbound. Continue for approximately 3 miles straight over 4 roundabouts. Continue past the viaduct on the right-hand side and at the next roundabout turn right on to Gorsebrook Road. Continue 400 yards passing under the viaduct and turn right. We are situated at the end of the road.

BY RAIL: The nearest train station is Wolverhampton which is about 1 mile from the racecourse. There are taxis available from outside the station. For further information, please telephone the National Rail Enquiry line on 08457 48 49 50.



www.wolverhampton-racecourse.co.uk • Email: enquiries@wolverhampton-racecourse.co.uk

Wolverhampton Racecourse, Dunstall Park, Wolverhampton WV6 0PE • Tel: 01902 421 421 • Fax: 01902 716 626

Wolverhampton Racecourse is a subsidiary of Arena Leisure Plc